



**QUICK REFERENCE GUIDE**  
**Model LZ6220**

**HOW TO INSTALL BATTERIES**

1. Take off the battery case cover, then connect the battery pack into the remote unit.
2. When loading, be sure to properly attach the rechargeable battery cable connector to the LR socket.
3. Put the battery case cover back on.

**HOW TO CHARGE BATTERIES**

1. Connect the AC adapter to the charging terminal. The red LED indicator on the cradle will illuminate.
2. Put the remote unit on the docking charger. Be sure to align the contacts properly. The 4 red uppers device mode keys should be in a moving pattern from left to right to indicate the LR is charging.

**HOW TO SET UP YOUR LA-Z-BOY REMOTE (LR)**

**By entering Device Code**

1. Turn on your A/V device. (e.g. TV)
2. Press a device key on your remote. (e.g. TV or DVD).
3. Hold down "CHANNEL +" and "VOLUME -" on the remote for 2 seconds until the upper 4 red device mode indicators light up.
4. Enter the four digit device code. All device mode keys will flash twice and go out immediately.

**By searching through the library**

1. Turn on your AV device. (e.g. TV)
2. Press a device key on your remote. (e.g. TV).
3. Hold down "CHANNEL +" and "VOLUME -" on the remote for 2 seconds until the upper 4 red device mode indicators light up.
4. Enter a corresponding code from the following table. The indicator should go out immediately.

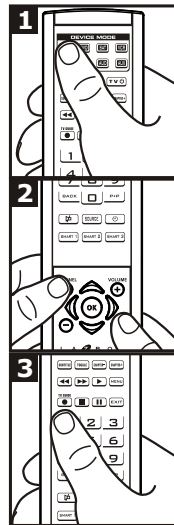

DEVICE TYPE:	TV	VCR/LASER DISC	SAT	CABLE	DVD	AUDIO	CD	HOME THEATER
SEARCH CODE:	0001	0002	0003	0004	0005	0006	0007	0008

5. Press the same device key on the remote again. (e.g. TV)
6. Hold down "CHANNEL +" and "VOLUME -" on the remote again, until the upper 4 red device mode indicators light up.. The remote is ready to start searching.
7. Aim the remote to the device (e.g. TV); press the "⏻" key repeatedly every 1-2 seconds until the device is switched off. The upper 4 red device mode indicators will blink once each time you press the "⏻" (power) key to indicate your remote is scrolling thru the code library. Once your device has been switched off, immediately press the same device mode key (e.g. TV) to lock in the search code and the upper 4 red device mode indicators will flash 3 times and your programmed device mode key should remain lit.

**By learning**

1. Press a device key on your remote. (e.g. TV).
2. Hold down "CHANNEL +" and "VOLUME -" on the remote for 2 seconds until the upper 4 red device mode indicators light up.
3. Enter the learning code "0", "0", "0", "0". The upper 4 red device mode indicators (TV, DVD, SAT, VCR) flash once and then stay lit continuously.
4. Place the LR and your device remote on a flat surface, aimed at each other 1-3 inches apart.
5. Press a desired key on your LR where you want the learned function from your original equipment remote to be located.
6. Press and keep holding the key on your original equipment remote which you want to learn for a few seconds.
7. When the upper 4 red device mode indicators flash twice and then stay lit continuously, the command has been learned successfully and you can release the key on your original equipment device remote.
8. Repeat from step 5 to learn other key functions, or press the same device mode key on step 1 (e.g. TV) to terminate the learning mode.

**By Online programming**

- Visit [www.lazyboyremotes.com](http://www.lazyboyremotes.com) .
- Select "support", then "code download".
- Click the LR online image on the screen to download the software interface.
- follow the steps illustrated

For a detailed description of all functions, please refer to the Installation Guide included with your La-z-boy Remote. You can also view an online tutorial on our website [www.lazboyremotes.com](http://www.lazboyremotes.com)

La-Z-Boy is a Trademark of La-Z-Boy Incorporated and is used under license to

Elexa Consumer Products, Inc. ©2008  
 6200 N. Hiawatha Ave, 8th Floor Chicago, IL 60646